

JUMP & SLIDE PARK



LANDING ON A CLOUD // ENTER THE WORLD OF BAGJUMP®



Index

4 Jump & Slide Park

14 Turnkey Park

15 References

16 Branding

18 Material

20 Park Safety

22 Park Features

42 Facts

Jump & Slide Park

UPGRADE YOUR SUMMER BUSINESS WITH A BAGJUMP® JUMP & SLIDE PARK

Jump & Slide Parks offer turnkey business solutions with a high return on investment, typically within two years. We provide expert consultation to optimize your available space and deliver an innovative family-friendly park. All you need to do is provide the land, staff, and integrate the park with your payment system!



- ✓ 2 different turnkey parks:
Large or X-Large
- ✓ Low operational costs
- ✓ Realize your return on investment in under 2 years³
- ✓ Temporary structure for seasonal use or permanent structure for all year use
- ✓ 4 innovative family and fun park features
- ✓ TÜV certified safety and certified staff training

³ Based on the Jump & Slide Park X-Large with 4 features.

CUSTOM JUMP & SLIDE PARK

individual features

Jump Tower small 1-3 platforms



Page 24

Jump Tower medium 2-3 platforms



Page 26

Jump Tower large 2-3 platforms



Page 28

Freedrop & Tubing Tower Combo



Page 30

Tubing Jump flatland 1-2 lane



Page 32

Tubing Jump on hill 1-2 lane



Page 34

Trampoline Airbag Station 1-3 lane



Page 36

Outdoor Action Park

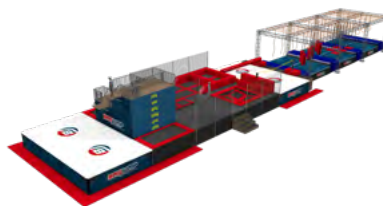

Page 38

Ninja Warrior Course 1-2 lane



Page 40

- ✓ Custom park – choose from 13 different features
- ✓ Shorten your ROI time by adding more park features
- ✓ 150+ different park setups possible
- ✓ Maximize utilization of your available space
- ✓ Add individual park features to your existing outdoor or indoor offerings²
- ✓ Attractions designed for different age groups starting at 2 years old

² Depending on location, regulations and capacity

Jump & Slide Park

JUMP & SLIDE PARK LARGE

The Large “Jump & Slide Park” includes three exciting family-friendly features and is available as either a permanent structure for year-round use or a temporary structure for seasonal use, which can be easily stored when not in operation. This turnkey park is a comprehensive business solution, ready to integrate seamlessly into your existing setup—simply add your payment terminal, and you’re ready to go!



FEATURES

- Single tubing jump slide 7 m (22.9 ft) tall
- 3-platform jump tower:
2.5m / 4 m / 5.5m □ 8.2ft / 13.1 ft / 18 ft
- 2-lane trampoline airbag station

INCLUDING

- 300 m² (984.2 ft²) space for branding on the tower
- 60 m² (196.8 ft²) space for branding on the airbag
- Video surveillance system
- Certified playground flooring¹
- Park management plan
- On-site installation
- Perimeter fence for park security
- All operating equipment
- Tubing lift, dry slope surface, 10 x tubing tubes
- Comprehensive risk management plan
- Full certification for operations permit²
- Staff training assessment
- Delivery¹

OPTIONAL

- Jump-distance and speed measure system
- Automated photo- and video-system with RFID and social media integration (automated upload)

QUICK FACTS

- 50** Visitors / hourly capacity
- 0.5%** Maintenance cost per year
- 1** Operating staff member⁴
- 2** Year ROI³
- 9 kWh** Energy consumption per hour
- 20x45m** Required area (65.6 x 147.6 ft)
- 3x40ft** Container storage (if temporary)
- 10 days** Setup time

RECOMMENDED TICKET PRICE

15-20\$ per hour / per person

UPGRADES

Single tubing → Double tubing

2-lane trampoline station → 3-lane trampoline station



7-12



13-18



19-50+



¹ Price can vary due to countries specific requirements. ² Depending on location, regulations and capacity. ³ Based on the Jump & Slide Park X-Large with 4 features. ⁴ Depending on local laws and regulations.

Jump & Slide Park





Jump & Slide Park

JUMP & SLIDE PARK X-LARGE

The X-Large “Jump & Slide Park” offers four thrilling, family-friendly attractions and is available as either a permanent structure for year-round use or a temporary structure for seasonal use, which can be conveniently stored when not in operation. This ready-to-use park is a complete business solution, designed to integrate effortlessly into your existing setup—just add your payment terminal, and you’re all set!



FEATURES

- Single tubing jump slide 10m (32.8 ft) tall
- 3-platform jump tower:
5m / 7m / 10m □ 16.4ft / 22.9ft / 18ft
- 3-lane Trampoline Airbag Station

INCLUDING

- 380m² (1246.7ft²) space for branding on the tower
- 120m² (393.7ft²) space for branding on the airbag
- Video surveillance system
- Certified playground flooring¹
- Park management plan
- On-site installation
- Perimeter fence for park security
- All operating equipment
- Tubing lift, dry slope surface, 10x tubing tubes
- Comprehensive risk management plan
- Full certification for operations permit²
- Staff training assessment
- Delivery¹

OPTIONAL

- Jump-Distance and speed measure system
- Automated photo- and video-system with RFID and social media integration (automated upload)

QUICK FACTS

- 60** Visitors / hourly capacity
- 0.5%** Maintenance cost per year
- 2** Operating staff member⁴
- 2** Years ROI³
- 13.5 kWh** Energy consumption per hour
- 25x55m** Required area (82x180.4ft)
- 3x40ft** Container storage (if temporary)
- 14 days** Setup time

RECOMMENDED TICKET PRICE

15-20\$ per hour / per person

UPGRADES

Single tubing → Double tubing
Ninja Warrior Course

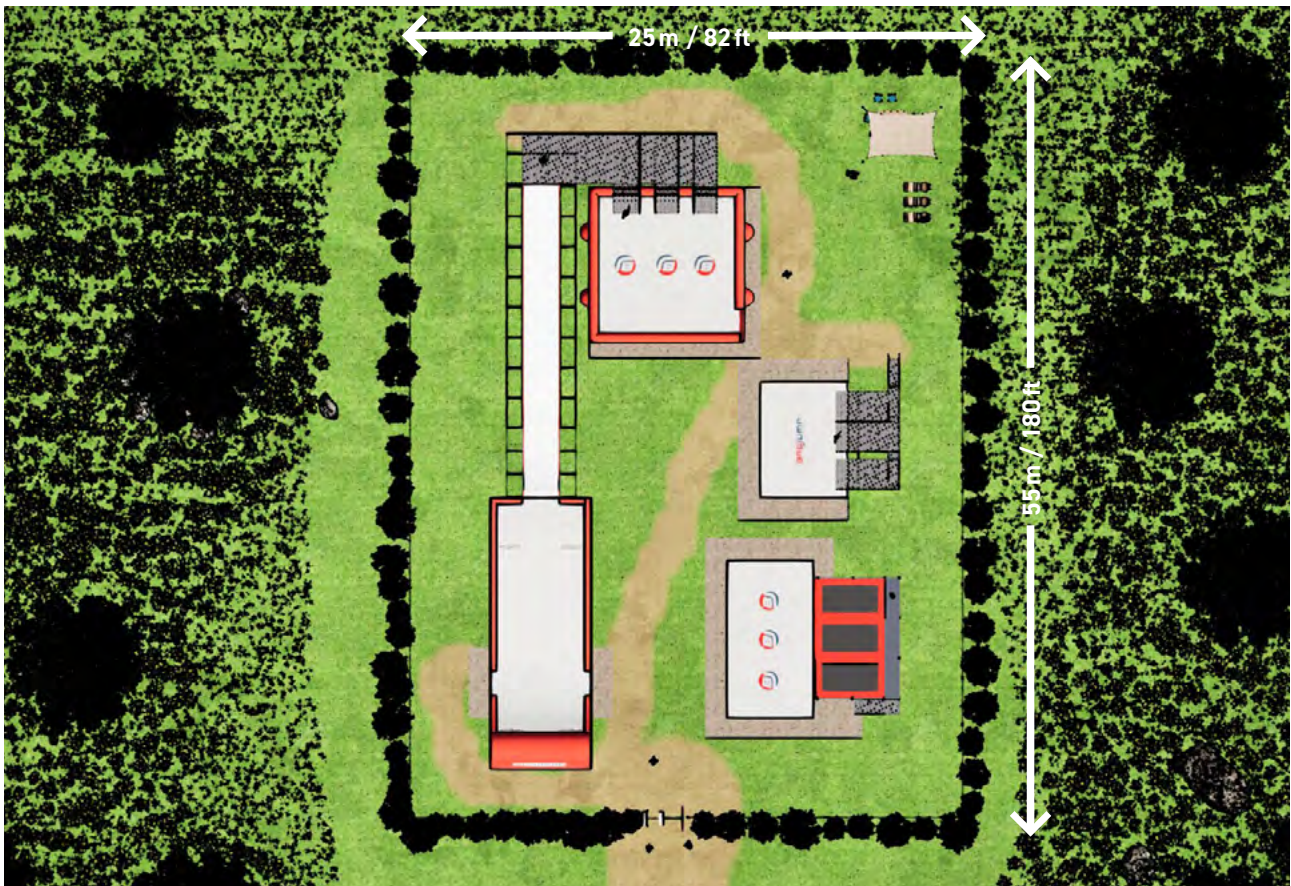

¹ Price can vary due to countries specific requirements. ² Depending on location, regulations and capacity. ³ Based on the Jump & Slide Park X-Large with 4 features. ⁴ Depending on local laws and regulations.

Jump & Slide Park

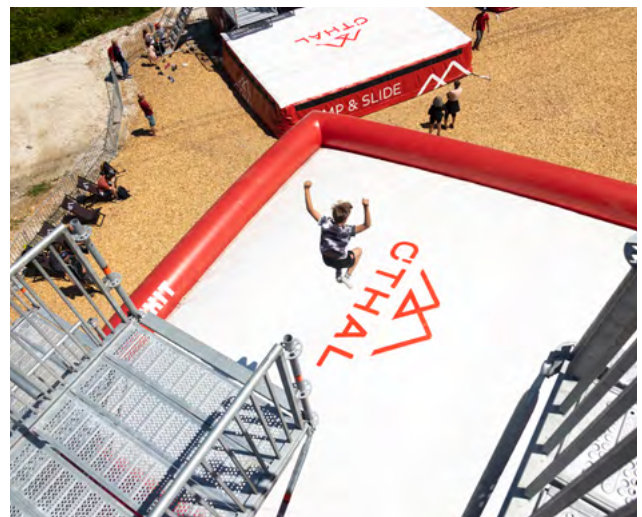



Turnkey Park

WHAT IS INCLUDED IN YOUR PARK PURCHASE?

Benefit from our turnkey solutions where we transform the individual features into a complete turnkey ride. Our technicians custom-build the park to suit your specific location and requirements, assisting with operations planning and branding options. These features offer high returns on investment for your park at low costs, providing safe and exciting experiences for your customers!

WHAT WE PROVIDE:

- Turnkey business with 2 years ROI³
- Setup in 2 weeks
- Fully branded park
- Ready to integrate with your payment system
- Safety certifications for operating permits²
- Surveillance system for each feature
- Temporary or permanent structure
- Marketing concept
- Certified staff training
- Huge surface for sponsors or messages

JUMP & SLIDE PARK

X-LARGE

- Suggested ticket price³** € 15-20 Euro /hour
- Hourly max. capacity³** 60 users
- ROI at full year operation³** 2 years
- Supervision staff required** 1-2 staff⁵
- Running / maintenance cost** low costs
- Warranty** 2 years
- Product lifespan** + 15 years

Possible income streams over 12 months

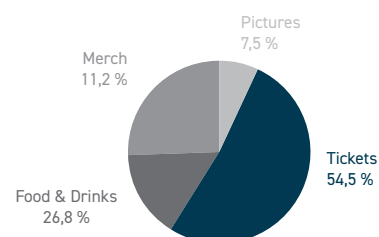

Invest over 12 months

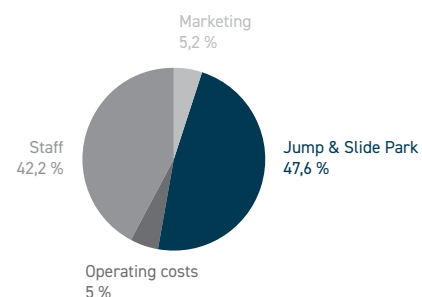

² Depending on location, regulations and capacity. ³ Based on the Jump & Slide Park X-Large with 4 features. ⁴ Depending on local laws and regulations. ⁵ Depending on amount of features and local regulations.

Trusted by the Best

"We introduced Bagjump's® airbag systems to our park a few years ago, and the feedback has been overwhelmingly positive. Not only have we seen a substantial increase in daily visitors, but the safe and exciting environment has also enhanced our guest reviews and overall satisfaction scores. The low maintenance costs and durability of the equipment ensure that we continue to deliver great value to our guests while maintaining a healthy profit margin. Bagjump® has undoubtedly helped elevate our park's appeal and profitability."

Reinhold Bauböck, Manager
@ Jump & Slide Park
Saalbach Hinterglemm, Austria

"The airbags in our adventure park are great fun for the whole family! They're super popular with younger and older kids and adults as well, providing a safe and thrilling experience that keeps everyone entertained for hours. Whether you're bouncing, flipping, or just enjoying the soft landing, these airbags add an extra layer of excitement to any adventure, making them a must-try for visitors of all ages."

Michael Unger, Manager
@ Funpark Drachental
Wildschönau, Austria

"Implementing the Jump & Slide Park from Bagjump® has been a game-changer for our adventure park. The ROI was evident within the first year, exceeding all our financial projections. Our guests love the variety and safety of the attractions, which has significantly increased repeat visits. The professional design and installation process was seamless, allowing us to launch ahead of our busiest season. Choosing Bagjump® was one of the best decisions we've made for our business growth and customer satisfaction."

Erik Schulze, Project Manager
@ Jump & Slide Park
Oberwiesental, Germany



✔ Branding

700 m² total advertisement space



- ✔ Photo-quality Print: Resistant to UVA and UVB rays
- ✔ Intelligent banner system: Designed for both tower and airbag structures
- ✔ Custom branding options: We can manage all design tasks, or you can provide files from your agency
- ✔ Flexible design changes: Easily alterable for seasonal updates or special events

Tower / Structure Advertising (380m² / 1246.7ft²)³

Customize the tower structures with your own designs or opt for our in-house graphics team to handle the design process. Perfect for showcasing sponsors or displaying your slogans and messages! Our tower banners are crafted from materials compliant with all wind static regulations and are digitally printed to achieve picture-quality results.



Airbag Branding (320m² / 1049.8ft²)³

For airbag branding, you have two options: permanent or temporary/replaceable. The permanent option involves direct screen printing, where each color is meticulously applied in multiple layers by hand using a stencil. The temporary or replaceable option utilizes direct digital sublimation printing on Bagjump® soft-touch banners, which are affixed to each side of the airbags using a Velcro banner system.



³ Based on the Jump & Slide Park X-Large with 4 features.

Material

We only process the best material

HEYtex®

AIRBAG MATERIALS

All BAGJUMP® materials are exclusively produced by Heytex technical textiles. We have developed these custom-made materials alongside HEYtex® over years of research and co-operation in order to guarantee high-performance, durable materials which are precisely suitable for their intended purpose. Whether it is for the high jump-frequency and year-round usage of a trampoline park, or the high impact energy of a freestyle motocross landing, we ensure that the materials are custom-tailored to withstand the short- and long-term stresses of their individual use.

Germany's HEYtex® Group are the world leaders in the development and production of high-quality, functional and technical textiles. HEYtex® have over 100 years of experience in R&D and production with certified quality and state-of-the-art technology.



Did you know that our printed topsheets have been treated with the anti-viral additive?

Long before Covid-19, we have been using an anti-bacterial and anti-viral additive in all of our printed soft touch topsheet materials. According to the information the additive manufacturer provides, it is 'effective against coronavirus and protects synthetic textiles. Treating PES textiles with this additive can reduce viral load by up to 99%.





PARK MATERIALS

We use only the highest quality materials designed for outdoor durability to ensure our parks last for over 15 years. All materials are certified and meet the required regulations for each park configuration.

WOOD

We utilize outdoor-treated wood, specifically heat-treated to maintain cleanliness and durability.

STEEL

Our constructions employ galvanized steel suitable for outdoor use, with the appropriate thickness and specifications to meet setup permit regulations.

WOOD CHIPS / RUBBER FLOORING

The wood chips, selected for their compliance with playground flooring regulations, cover the entire park surface. Alternatively, we use rubber flooring that also meets the outdoor playground regulations.



✓ Park Safety

BAGJUMP® pressure alarm system



Enhance the safety standards of your BAGJUMP® Airbag or any other inflatable device with the new BAGJUMP® Pressure Alarm. In the unlikely event of any airbag pressure deviations or power failure, the BAGJUMP® Pressure Alarm will promptly activate an audio-visual signal, instantly alerting both users and staff. The Pressure Alarm also features a DMX port for seamless integration into your light and audio system. This enables you to trigger specific light and sound effects or make important announcements when the alarm activates. Complying with the latest industry regulations, this product is built in accordance with recognized safety standards and guidelines.

As of 2022, ISO 23659:2022 has made the Pressure Alarm feature mandatory for trampoline parks, ensuring a vigilant monitoring of your inflatable structures.



New pressure alarm system with WiFi compatibility → Pressure Alarm Gen2



GET YOURS NOW!

- ✓ Enhanced safety
- ✓ Prompt audio-visual alerts
- ✓ Seamless integration
- ✓ Industry compliance
- ✓ Easy implementation
- ✓ Protects investment



Warning signal lamp included



VIDEO SURVEILLANCE SYSTEM

- Monitors visitor activity
- Saves data and video files for future reference
- Provides anti-theft protection at night with integrated light sensors



RISK ASSESSMENT STRATEGY

- Addresses potential injury scenarios
- Outlines response protocols for various incidents within the park
- Establishes operational guidelines for safety



PERIMETER SECURITY FENCE

- Secures the park against unauthorized access
- Offers protection from vandalism
- Lockable gates delineate and secure the park boundary



STAFF TRAINING AND ON-SITE INSTALLATION

- Comprehensive on-site training for up to 10 staff members
- Instructs on the use and operation of all structures and airbags
- Guides on how to maintain daily and monthly logbooks
- Covers safe operation procedures for each structure
- Ensures professional installation of all structures and airbags by a Bagjump®-certified installer

✓ Park Features

CUSTOM JUMP & SLIDE PARK

Select from 15 unique park features and tailor your Jump & Slide Park with individual configurations, offering over 150+ setup possibilities. Each feature can be implemented as either a permanent or temporary structure. This turnkey solution can be integrated as standalone attractions in your existing park or combined to form a distinct Jump & Slide Park!



Jump Tower small 1 platform



Jump Tower small 2 platforms



Jump Tower small 3 platforms



Jump Tower medium 2 platforms



Jump Tower medium 3 platforms



Jump Tower large 2 platforms



Jump Tower large 3 platforms



Tubing Jump flatland 1 lane



Tubing Jump flatland 2 lane



Tubing Jump on hill 1 lane



Tubing Jump on hill 2 lane



Freedrop & Tubing Tower Combo large single tube



Freedrop & Tubing Tower Combo X-Large single tube



Freedrop & Tubing Tower Combo X-Large double tube



Freedrop & Tubing Tower Combo large double tube



Trampoline Airbag Station 1 lane



Trampoline Airbag Station 2 lane



Trampoline Airbag Station 3 lane

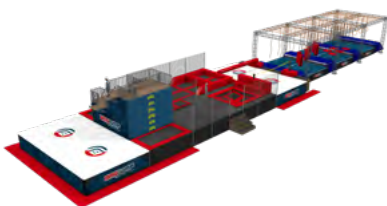

Outdoor Action Park

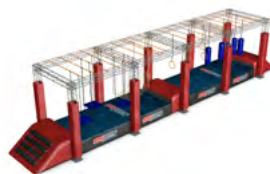

Ninja Warrior Course 1 lane

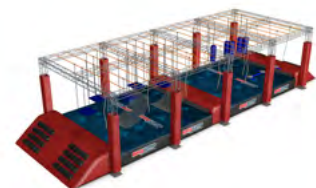

Ninja Warrior Course 2 lane

- ✓ Individual Park configurations of 150+ different park setups!
- ✓ Boost your ROI by adding 4 or more features into one Park!
- ✓ Add individual features to your existing park!

Jump Tower small 1-3 platforms

FEATURES

- Jump tower steel / wood
- Permanent or temporary structure
- 1-3 jump platforms:
 - 1 jump platform 4m □ 13,1ft
 - 2 jump platforms 3.5m / 5m □ 11.4ft / 16.4ft
 - 3 jump platforms 2.5m / 3.5m / 5m □ 8.2ft / 11.4ft / 16.4ft

INCLUDING

- 25-80 m² (82-262.4ft²) space for branding on the tower
- 20-30 m² (65.6-98.4ft²) space for branding on the airbag
- Park management plan
- On-site installation
- All operating equipment
- Comprehensive risk management plan
- Full certification for operations permit²
- Staff training assessment
- Delivery¹

OPTIONAL

- Video surveillance system
- Certified playground flooring¹
- Perimeter fence for park security
- Automated photo- and video-system with RFID and social media integration (automated upload)

QUICK FACTS

30-60	Visitors / hourly capacity
0.5%	Maintenance cost per year
1	Operating staff member ⁴
2	Years ROI ³
1.5-3 kWh	Energy consumption per hour
12x10m	Required area 1 platform (39.3 x 32.8 ft)
12x13m	Required area 2 platform (39.3 x 42.6 ft)
12x16m	Required area 3 platform (39.3 x 52.4 ft)
1x40ft	Container storage (if temporary)
1-2 days	Setup time

RECOMMENDED TICKET PRICE

- Operated as individual attraction: 2-5\$/jump
- In combination with 3 or more features: 15-20\$/hour

UPGRADES

Upgrade to four or more platforms, depending on the available space, to increase your hourly capacity by 10 people per platform.



7-12



13-18



19-50+



Jump Tower small 1 platform



Jump Tower small 2 platforms



Jump Tower small 3 platforms

¹ Price can vary due to countries specific requirements. ² Depending on location, regulations and capacity. ³ Based on the Jump & Slide Park X-Large with 4 features. ⁴ Depending on local laws and regulations.



Jump Tower medium 2-3 platforms

FEATURES

- Jump tower steel / wood
- Permanent or temporary structure
- 2-3 jump platforms:
 - 2 jump platforms 4 m / 6 m □ 13.1 ft / 19.6 ft
 - 3 jump platforms 4 m / 6 m / 7 m □ 13.1 ft / 19.6 ft / 22.9 ft

INCLUDING

- 25-80 m² (82-262.4 ft²) space for branding on the tower
- 20-30 m² (65.6-98.4 ft²) space for branding on the airbag
- Park management plan
- On-site installation
- All operating equipment
- Comprehensive risk management plan
- Full certification for operations permit²
- Staff training assessment
- Delivery¹

OPTIONAL

- Video surveillance system
- Certified playground flooring¹
- Perimeter fence for park security
- Automated photo- and video-system with RFID and social media integration (automated upload)

QUICK FACTS

- 30-60** Visitors / hourly capacity
- 0.5%** Maintenance cost per year
- 1** Operating staff member⁴
- 2** Years ROI³
- 4.5 kWh** Energy consumption per hour
- 14x13m** Required area 2 platform (45.9 x 42.6 ft)
- 14x16m** Required area 3 platform (45.9 x 52.4 ft)
- 1x40ft** Container storage (if temporary)
- 1-2 days** Setup time

RECOMMENDED TICKET PRICE

- Operated as individual attraction: 2-5\$ / jump
- In combination with 3 or more features: 15-20\$ / hour

UPGRADES

Upgrade to four or more platforms, depending on the available space, to increase your hourly capacity by 10 people per platform.



7 - 12



13 - 18



19 - 50+



Jump Tower medium 2 platforms



Jump Tower medium 3 platforms

¹ Price can vary due to countries specific requirements. ² Depending on location, regulations and capacity. ³ Based on the Jump & Slide Park X-Large with 4 features. ⁴ Depending on local laws and regulations.

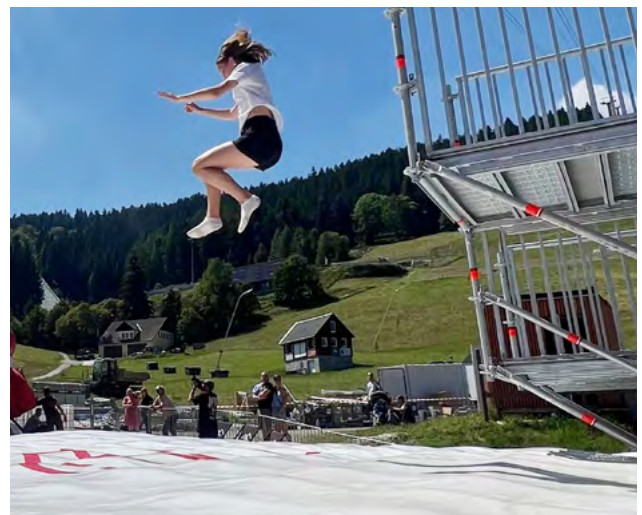
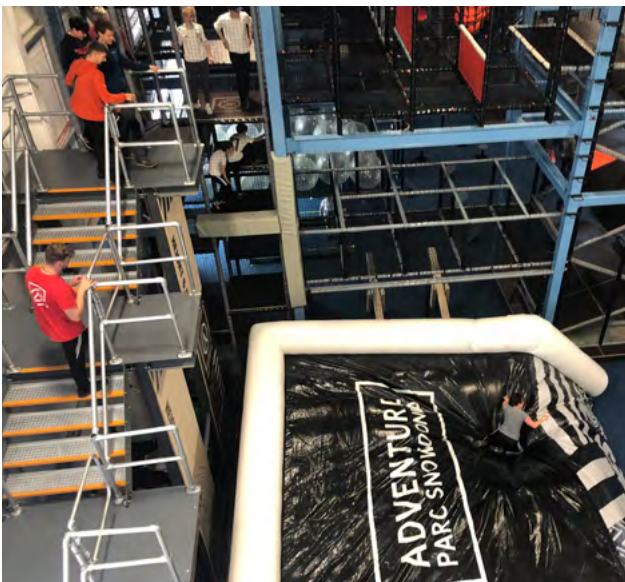

Jump Tower large 2-3 platforms

FEATURES

- Jump Tower steel / wood
- Permanent or temporary structure
- 3-platform jump tower:
5m / 7m / 10m □ 16.4ft / 22.9ft / 18ft

INCLUDING

- 200m² (656.1ft²) space for branding on the tower
- 40m² (131.2ft²) space for branding on the airbag
- Park management plan
- On-site installation
- All operating equipment
- Comprehensive risk management plan
- Full certification for operations permit²
- Staff training assessment
- Delivery¹

OPTIONAL

- Video surveillance system
- Certified playground flooring¹
- Perimeter fence for park security
- Automated photo- and video-system with RFID and social media integration (automated upload)

QUICK FACTS

- 40** Visitors / hourly capacity
- 0.5%** Maintenance cost per year
- 2** Operating staff member⁴
- 2** Years ROI³
- 4.5 kWh** Energy consumption per hour
- 15x17m** Required area (49.2 x 55.7 ft)
- 2x40ft** Container storage (if temporary)
- 2 days** Setup time

RECOMMENDED TICKET PRICE

- Operated as individual attraction: 2-5\$/jump
- In combination with 3 or more features: 15-20\$/hour

UPGRADES

Single tubing → Double tubing

2-lane trampoline station → 3-lane trampoline station



7-12



13-18



19-50+



Jump Tower large 2 platforms



Jump Tower large 3 platforms

¹ Price can vary due to countries specific requirements. ² Depending on location, regulations and capacity. ³ Based on the Jump & Slide Park X-Large with 4 features. ⁴ Depending on local laws and regulations.



Freedrop & Tubing Tower Combo

FEATURES

- **Large:**
Single tubing jump slide 7 m (22.9 ft) tall with 3-platform jump tower: 2.5 m / 4 m / 5.5 m □ 8.2 ft / 13.1 ft / 18 ft or
- **X-Large:**
Single tubing jump slide 10 m (32.8 ft) tall with 3-platform jump tower: 5 m / 7 m / 10 m □ 16.4 ft / 22.9 ft / 18 ft

INCLUDING

- 300-380 m² (984.2-1,246.7 ft²) space for branding on the tower
- 40-60 m² (131.2-196.8 ft²) space for branding on the airbag
- Park management plan
- On-site installation
- All operating equipment
- Tubing lift, dry slope surface, 10x tubing tubes
- Comprehensive risk management plan
- Full certification for operations permit²
- Staff training assessment
- Delivery¹

OPTIONAL

- Jump-Distance and speed measure system
- Video surveillance system
- Certified playground flooring¹
- Perimeter fence for park security
- Automated photo- and video-system with RFID and social media integration (automated upload)

QUICK FACTS

- 30-60** Visitors / hourly capacity (30 single / 60 double)
- 0.5 %** Maintenance cost per year
- 1-2** Operating staff member⁴
- 2** Years ROI³
- 9 kWh** Energy consumption per hour
- 55x17 m** Required area (180.4 x 55.7 ft)
- 2-3 x 40 ft** Container storage (if temporary)
- 10-14 days** Setup time

RECOMMENDED TICKET PRICE

- Operated as individual attraction: 2-5 \$ / jump
- In combination with 3 or more features: 15-20 \$ / hour

UPGRADES

- Single tubing → Double tubing
- Double tubing → Triple tubing
- Triple tubing → Quadruple tubing



Freedrop & Tubing Tower Combo large single tube



Freedrop & Tubing Tower Combo X-Large single tube



Freedrop & Tubing Tower Combo large double tube



Freedrop & Tubing Tower Combo X-Large double tube

¹ Price can vary due to countries specific requirements. ² Depending on location, regulations and capacity. ³ Based on the Jump & Slide Park X-Large with 4 features. ⁴ Depending on local laws and regulations.



Tubing Jump flatland 1-2 lane

FEATURES

- Tubing tower steel / wood
- Permanent or temporary structure

INCLUDING

- 300 m² (984.2 ft²) space for branding on the tower
- 40 m² (131.2 ft²) space for branding on the airbag
- Park management plan
- On-site installation
- All operating equipment
- Tubing lift, dry slope surface, 10 x tubing tubes
- Comprehensive risk management plan
- Full certification for operations permit²
- Staff training assessment
- Delivery¹

OPTIONAL

- Jump-Distance and speed measure system
- Video surveillance system
- Certified playground flooring¹
- Perimeter fence for park security
- Automated photo- and video-system with RFID and social media integration (automated upload)

QUICK FACTS

30-60	Visitors / hourly capacity (30 single / 60 double)
0.5%	Maintenance cost per year
1	Operating staff member ⁴
2	Years ROI ³
4.5 kWh	Energy consumption per hour
55 x 17 m	Required area (180.4 x 55.7 ft)
2-3 x 40 ft	Container storage (if temporary)
10-14 days	Setup time

RECOMMENDED TICKET PRICE

- Operated as individual attraction: 2-5\$/jump
- In combination with 3 or more features: 15-20\$/hour

UPGRADES

Single tubing → Double tubing

Double tubing → Triple tubing

Triple tubing → Quadruple tubing



7-12



13-18



19-50+



Tubing Jump flatland 1 lane



Tubing Jump flatland 2 lane

¹ Price can vary due to countries specific requirements. ² Depending on location, regulations and capacity. ³ Based on the Jump & Slide Park X-Large with 4 features. ⁴ Depending on local laws and regulations.



Tubing Jump on hill 1-2 lane

FEATURES

- Tubing inrun steel / wood
- Permanent or temporary structure

INCLUDING

- 40 m² (131.2 ft²) space for branding on the airbag
- Park management plan
- On-site installation
- All operating equipment
- Tubing lift, dry slope surface, 10 x tubing tubes
- Comprehensive risk management plan
- Full certification for operations permit²
- Staff training assessment
- Delivery¹

OPTIONAL

- Jump-Distance and speed measure system
- Video surveillance system
- Certified playground flooring¹
- Perimeter fence for park security
- Automated photo- and video-system with RFID and social media integration (automated upload)

QUICK FACTS

- 30-60** Visitors / hourly capacity (30 single / 60 double)
- 0.5%** Maintenance cost per year
- 1** Operating staff member⁴
- 2** Years ROI³
- 3 kWh** Energy consumption per hour
- 55x17 m** Required area (180.4 x 55.7 ft)
- 1 x 40 ft** Container storage (if temporary)
- 10-14 days** Setup time

RECOMMENDED TICKET PRICE

- Operated as individual attraction: 2-5\$ / jump
- In combination with 3 or more features: 15-20\$ / hour

UPGRADES

- Single Tubing → Double Tubing
- Double Tubing → Triple Tubing
- Triple Tubing → Quadruple Tubing



7 - 12



13 - 18



19 - 50+



Tubing Jump on hill 1 lane



Tubing Jump on hill 2 lane

¹ Price can vary due to countries specific requirements. ² Depending on location, regulations and capacity. ³ Based on the Jump & Slide Park X-Large with 4 features. ⁴ Depending on local laws and regulations.



Trampoline Airbag Station 1-3 lane

FEATURES

- Trampoline station galvanized steel + perimeter padding
- Permanent or temporary structure
- 1-3 Trampoline lanes

INCLUDING

- 15-30 m² (49.2 - 98.4 ft²) space for branding on the trampoline station
- 20-30 m² (65.6 - 98.4 ft²) space for branding on the airbag
- Park management plan
- On-site installation
- All operating equipment
- Comprehensive risk management plan
- Full certification for operations permit²
- Staff training assessment
- Delivery¹

OPTIONAL

- Video surveillance system
- Certified playground flooring¹
- Perimeter fence for park security
- Automated photo- and video-system with RFID and social media integration (automated upload)

QUICK FACTS

30-60	Visitors / hourly capacity
0.5%	Maintenance cost per year
1	Operating staff member ⁴
2	Years ROI ³
1.5 - 3 kWh	Energy consumption per hour
12x10m	Required area 1 platform (39.3 x 32.8 ft)
12x13m	Required area 2 platform (39.3 x 42.6 ft)
12x16m	Required area 3 platform (39.3 x 52.4 ft)
1x40ft	Container storage (if temporary)
1-2 days	Setup time

RECOMMENDED TICKET PRICE

- Operated as individual attraction: 2-5\$/jump
- In combination with 3 or more features: 15-20\$/hour

UPGRADES

Upgrade to four or more trampoline lanes based on available space to increase your hourly capacity by 10 people per lane.



2-6



7-12



13-18



19-50+



Trampoline Airbag Station 1 lane



Trampoline Airbag Station 2 lane



Trampoline Airbag Station 3 lane

¹ Price can vary due to countries specific requirements. ² Depending on location, regulations and capacity. ³ Based on the Jump & Slide Park X-Large with 4 features. ⁴ Depending on local laws and regulations.



Outdoor Action Park

FEATURES

- **4 individual modules**
 - **Action Station:** Parkour Elements, Wallrunning, Jump Platforms 3m+5m, ages 12+
 - **Trampoline Area:** 14 individual trampolines in various configurations, chillout area, ages 6+
 - **Balance Area:** Slackline, Battle/Balance-beam, low jump platforms of 0.5m and 1m, ages 6+
 - **Ninja Course:** double or single ninja warrior course with 3-6 ninja modules/stations, various obstacles for various age/skill levels, ages 6+
- Permanent or temporary structure
- 3 jump platforms
- Slack line + battle beam

INCLUDING

- 50-150 m² (164-492.1 ft²) possible branding space per module
- Park management plan
- On-site installation
- All operating equipment
- Comprehensive risk management plan
- Full certification for operations permit²
- Staff training assessment
- Delivery¹

OPTIONAL

- Automated photo- and video-system with RFID and social media integration (automated upload)

QUICK FACTS

- 30-90** Visitors / hourly capacity depending on amount of modules
- 0.5%** Maintenance cost per year
- 1-2** Operating staff member⁴
- 2** Years ROI³
- 4.5-7.5 kWh** Energy consumption per hour
- 10.5 x 10.5 m Action Station** (34.45 x 34.45 ft)
- 10.5 x 10.5 m Trampoline Area** (34.45 x 34.45 ft)
- 10.5 x 10.5 m Balance Area** (34.45 x 34.45 ft)
- 7 x 10 m Ninja Course** (22.97 x 32.81 ft)
- 2-3 x 40 ft** Container storage (if temporary)
- 1-2 weeks** Setup time (depending on amount of modules)

RECOMMENDED TICKET PRICE

- 15-20\$ per hour / per person

UPGRADES

Enhance your setup by adding additional trampoline fields, jump platforms, and a boulder area, automated video/photo system, and much more tailored to your budget and available space.



2-6



7-12



13-18



19-50+

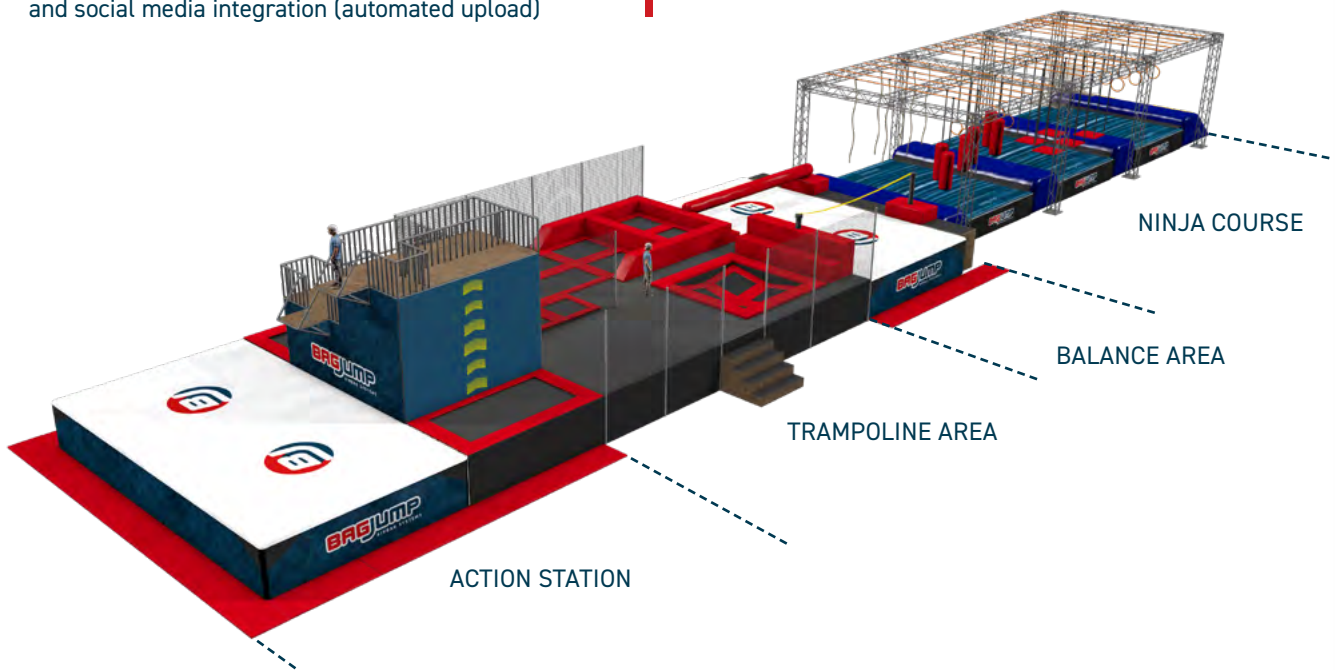

¹ Price can vary due to countries specific requirements. ² Depending on location, regulations and capacity. ³ Based on the Jump & Slide Park X-Large with 4 features. ⁴ Depending on local laws and regulations.

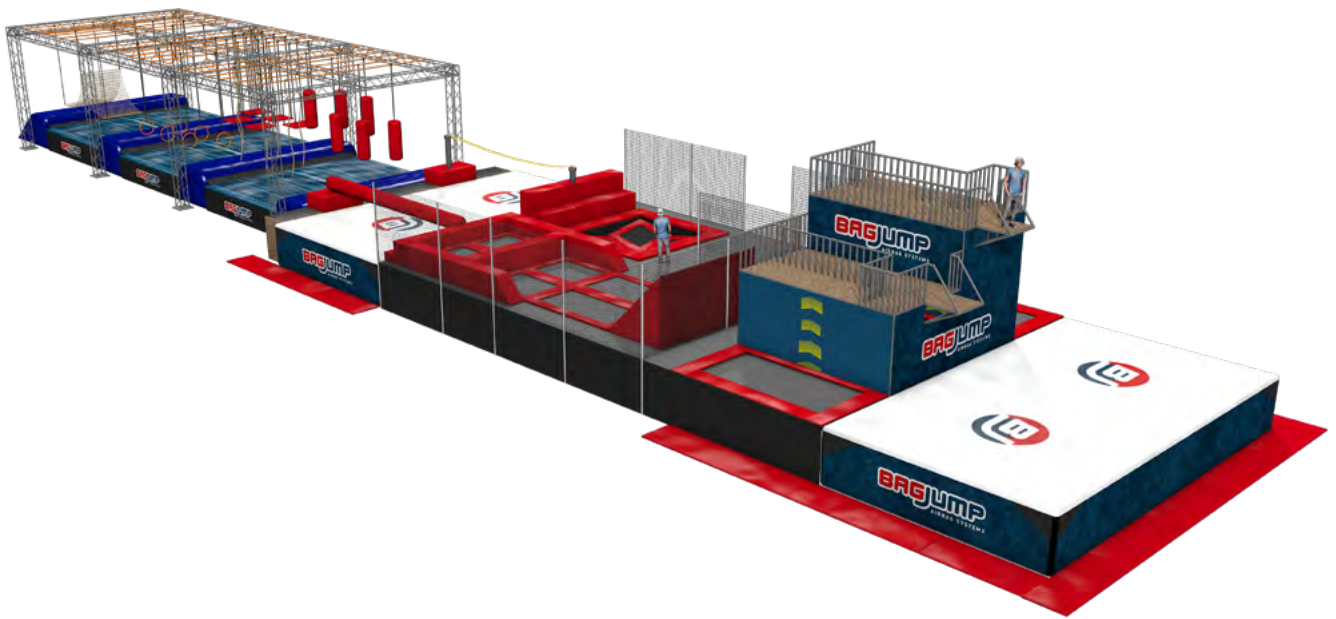
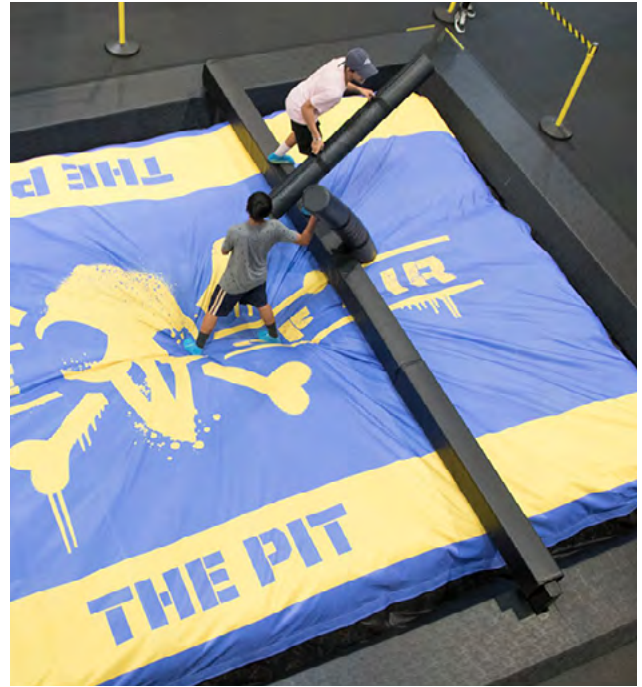

Ninja Warrior Course 1-2 lane

FEATURES

- Ninja Warrior frame galvanized steel in 10m sections
- Permanent or temporary structure
- 4x Ninja Warrior obstacles per section

INCLUDING

- 100 m² (328 ft²) space for branding on the ninja warrior frame
- 40-80 m² (131.2 - 262.4 ft²) space for branding on the airbag
- Park management plan
- All operating equipment
- Comprehensive risk management plan
- Full certification for operations permit²
- Staff training assessment
- Delivery¹

OPTIONAL

- Video surveillance system
- End-of-time buzzer with integrated timer
- Perimeter fence for park security
- Automated photo- and video-system with RFID and social media integration (automated upload)

QUICK FACTS

- 40-80** Visitors / hourly capacity
- 0.5%** Maintenance cost per year
- 1** Operating staff member⁴
- 2** Years ROI³
- 3 kWh** Energy consumption per hour (per 10m module)
- 44x7m** Required area 1 lane (144.3x22.9 ft)
- 44x10m** Required area 2 lane (144.3x32.8 ft)
- 1x40ft** Container storage (if temporary)
- 2 days** Setup time

RECOMMENDED TICKET PRICE

- 15-20\$ per hour / per person

UPGRADES

The Ninja Warrior course can be extended indefinitely by adding more sections. With endless variations of Ninja Warrior obstacles available, enhance your course with the latest designs as seen on TV!



7 - 12



13 - 18



19 - 50+

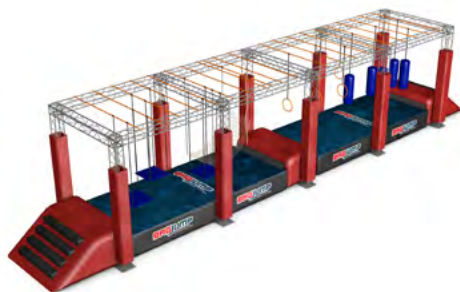

Ninja Warrior Course 1 lane



Ninja Warrior Course 2 lane

¹ Price can vary due to countries specific requirements. ² Depending on location, regulations and capacity. ³ Based on the Jump & Slide Park X-Large with 4 features. ⁴ Depending on local laws and regulations.

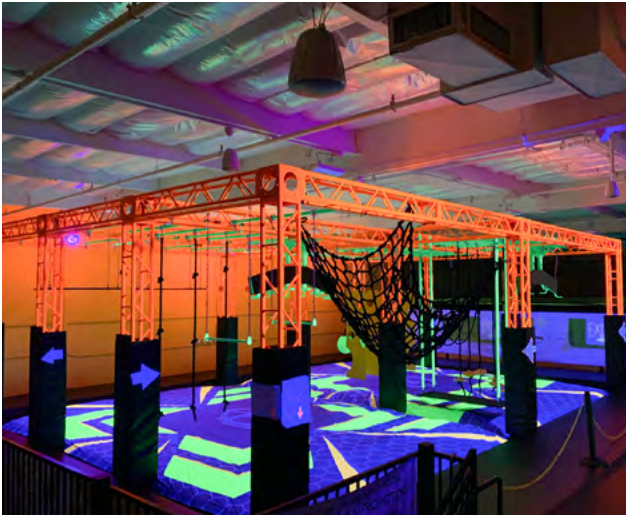

Why BAGJUMP®

With our rich action sports heritage, BAGJUMP® is the industry leader in airbag innovation, offering high-performance, low-maintenance, hygienic and long-lasting airbag systems for sports, leisure and safety applications.

1

PASSION

At BAGJUMP® we feel extremely fortunate to be involved in the progression of extreme sports and revolutionizing the leisure industry to bring better and safer experiences to adrenaline seekers everywhere. We love what we do and are excited to push things forward!

2

INNOVATION

Innovation in any sphere takes courage. We have been innovating airbag technology alongside many of the world's leading athletes and brands over the last decade in order to achieve the unthinkable. It excites us to see how our prototypes progress from development to practical application, allowing the world's best to test the limits of possibility.

3

EXPERIENCE

Through our track record of over 5,000 successful projects across various fields globally, we have gained extensive expertise in safety, functionality, manufacturing, and materials of airbag systems. Our in-house engineers possess the prowess to swiftly turn conceptual ideas into tangible reality.

4

INTERNATIONALLY CERTIFIED

All BAGJUMP® products are certified by TÜV for quality. We work together closely with our industry regulators and have played a large role in assisting the writing of various country and industry standards, such as the IATP, ASTM or BSI code of practice.







Enter the World
of BAGJUMP®!

BAGJUMP® Action Sports GmbH // Europe

Schlöglstrasse 55
6060 Hall in Tirol, Austria

P +43 (0) 5223 21421
E office@bagjump.com

BAGJUMP® Action Sports INC // North America

101 Copperwood Way, Suite G/H
Oceanside, CA 92058, USA

P +1 (310) 625-4258
E usa@bagjump.com // canada@bagjump.com

 bagjumpTV

 bagjump

 bagjump

 bagjump-airbag-systems